

Safety instruction

General Safety Instructions

- Manufacturer takes no responsibility for any damage caused by incorrect use.
- Incorrect or improper use can damage the appliance and cause injuries to the user.
- This appliance can be used by children aged from 6 years and above and persons with reduced physical, sensory or mental capabilities or lack of experience and knowledge if they have been given supervision or instruction concerning use of the appliance in a safe way and understand the hazards involved.
- Product contains small parts. Children shall under **no circumstances** play with the appliance. The product is **not a toy!**
- Cleaning and user maintenance shall not be made by children without supervision.
- **Only** use accessories evaluated for use with this product.
- **Never** attempt to drive any objects into the appliance.
- **Never attempt** to open the housing yourself!
- Household use only!

Notes on handling batteries

⚠ WARNING:

- **Batteries must not be recharged, taken apart, thrown into an open fire or short circuited. Risk of fire/explosions!**
- **Keep the batteries out of the reach of small children. They are no toys!**
- Swallowing batteries can be extremely dangerous. Should a child swallow a battery, seek medical assistance, immediately.
- If a battery leaks, avoid contact with your eyes and skin. If the fluid should come into contact with your eyes or skin, rinse with clear water immediately and seek medical assistance, if necessary.

Caution: Always replace all batteries at the same time and always use the same battery type.

Batteries can contain toxins that are harmful to your health and the environment. Always dispose of batteries in accordance with applicable legal regulations.

Do **not** dispose of batteries with the normal household waste.

Before use, please read these instructions carefully and keep them in a safe place for future reference.

Introduction

The treatment of wetting or bed-wetting (Technical term: Nocturnal enuresis) with a bed wetting alarm device like the pee sensor can be a solution to the problem. Through training, the non-existing reflex of waking up due to bladder pressure is trained up, according to today's knowledge, less than two "wet" incidents per month is considered normal!

Technical data

Piesel Piepser (Pee Sensor) HIMiNr: 15,25,18,0027 PZN: (07232676)
Receiver dimension: 90 x 60 x 30mm (H x B x T) Weight: 45g
Sender dimension: 55 x 30 x 8mm (H x B x T) Weight: 8g
Battery: 1 x Lithium CR2032 (3.0V), 3 x AAA (1,5V)

Note: Use only the type of battery specified for the pee sensor. Do **not** use any other type of battery.

Scope of Delivery

Pee sensor set
Battery pack
ON/OFF pin x 2 pcs
Operation instruction
Child's diary
Sticker set
Parent's diary
Screw driver
Plastic coin

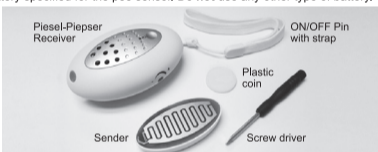

The Diaries

The **parent's diary** has to be completed by the parents. 4 columns are available for each day/night. For better control, detailed information should be entered according to the following criteria:

W = wet, complete bladder emptying into bed
UW = underpants wet

The **child's diary** has to be completed by the child. The child should get a sticker as a reward if it stays dry through the night or if no alarm went off. If the bed was wet the child should mark it down by pen in the diary.

BM = bed moist but not wet
D = Dry

Turn on the device



Receiver

On delivery the on/off pin is inserted into the device to ensure that the power supply is interrupted. As long as the on/off pin is inserted into the receiver, the device is switched off. Select the desired alarm mode (vibrate only, vibrate + sound or sound only). Activate the receiver by removing the on/off pin.

Caution: The On/Off pin must be removed before operation
Note: This product may operate incorrectly when it experiences ESD (Electro-Static discharge). In this case, reset it manually

Operation

Insert 3 AAA batteries into the receiver and 1 CR2032 button cell into sender.

Note: Make sure that the orange sealing ring in the sender is properly positioned.

Note 2: In case of a pairing problem, press and hold the pause button for 10 seconds until the receiver blinks and vibrates twice. This will reset the memory. Then try the pairing process again.

1. To do the bluetooth-pairing you have to push the pause/pairing button 3 times in a very short sequence; sender(s) in a <10m range will be paired.
Note 1: Only pair 1 sender and 1 receiver during the pairing process. Multiple unit pairing will could disrupt the pairing process.
Note 2: In case of a pairing problem, press and hold the pause button for 10 seconds until the receiver blinks and vibrates twice. This will reset the memory. Then try the pairing process again.
2. To check the pairing status, push the pairing button twice, the LED indicator will blink 4 times if the connection was successful.
3. Inserting the on/off pin during the pairing process may cause malfunction.
4. The paired sender and receiver will takes approx. 30 seconds to reconnect once the on/off pin is unplugged.
5. If connection re-established, the receiver flashes green if the connection to the transmitter is lost. The blinking stops after 3-5 Sec. as soon as the connection is re-established.

Once the sender gets wet, the alarm will be activated. The red LED on the sender blinks 3 times and activates the receiver's alarm within 5 seconds.

If the sender is not removed from the wet underwear it will activate the alarm every minute.

Remove the sender from the wet underwear, clean it with a damp cloth, and dry it properly afterwards.

Reinsert the sender as described below.

As soon as the alarm is triggered, the green LED blinks for 2 minutes then starts again after 30 seconds.

Press the pause button to temporarily silence the alarm (alarm will be silenced for approx. 30 seconds).

Note: The alarm is completely switched off only when the on/off pin is inserted.

The volume of the receiver can be adjusted with the volume knob. Test the volume before using.

WARNING: The alarm's volume can reach up to 100dB within a distance of 30cm. To avoid the risk of hearing loss, **NEVER** put the receiver next to your ear!! The volume should only be adjusted with the supplied screwdriver. Turn the volume knob carefully to avoid any damage.

How to attach the device

1. Select the alarm mode
 - sound only
 - vibrate + sound
 - vibrate + vibrate + sound
2. Place and fix sender in the underpants (see picture).
NOTE: It is recommended to insert the sender into a common panty liner to avoid direct skin contact. Direct skin contact can activate false alarm and/or might lead to a sensitive skin reaction.
3. Pay attention to the signal of receiver!

Note: When the battery level is low, a reminder signal will sound.

Receiver: Red LED is blinking per 1 second

Sender: Red LED is blinking every 5 seconds. After 5 mins, the red LED is blinking every 10 to 20 seconds.

10 tips for successful training

1. Be Patient! Training and positive results need time!
2. Motivate your child.
3. The pee sensor has to be used every night.
4. Discuss the function of the sensor and also practice how to change the sensor in detail with your child.
5. Find out, where the placement of the device is the least displeasing for your child.
6. Encourage your child to go to the toilet before bedtime.
7. In the initial phase, the alarm is often not heard by the child. Therefore, wake your child in the first few days. After a few days, most of the children wake up by themselves.
8. After some time, the child should be able to turn off the alarm independently. Help him/her until this point is reached.
9. The enclosed diaries will help you to monitor the usage of the device.
10. After successful treatment, please send the diary to the distributor. You will receive a little surprise as a thank you! The data is used for statistical purpose only.

Possible faults and their elimination



The receiver does not sound an alarm

Exam: Function test by triggering (damp cloth or paper clip connecting contact shield) the sender, check if the sensors led is blinking (picture)

Cause 1: Sender is placed to deep into the panty liner.

Remedy: Relocate the sender

Cause 2: Battery is empty

Remedy: Replace the battery as described in the instructions

Cause 3: The device is defective

Remedy: Have it repaired by the dealer or manufacturer.

Cause 4: The battery is weak. The alarm sound is too low

Remedy: Replace the battery as described in the instructions

Battery replacement

Receiver: Unscrew the battery cover and replace 3 new Batteries (type: AAA)

Sender: Unscrew the battery cover using the plastic coin provided and replace 1 Battery (type: CR2032)

Note:

- Do **not** mix different types or new and used batteries
- Make sure battery is inserted with correct polarity according to the marking
- Exhausted batteries are to be removed from the appliance
- Remove the battery if the unit is stored unused for a long period of time
- Make sure supply terminals are not short circuited
- Non-rechargeable batteries are not to be recharged;
- Make sure the O ring on the sender is properly installed

Cleaning and Care

Before cleaning, always switch off the appliance and remove the battery. Never immerse the appliance in water.

Clean the body of the appliance with a moistened soft cloth.

Do **not** use any aggressive cleaning agents and/or other hard objects to clean the appliance.

Disposal Instruction

Standard and rechargeable batteries should not be thrown into regular household waste. As a consumer, you are legally obliged to return used batteries for proper disposal. You can hand in your used batteries at public collection points in your district or sales outlets where batteries of this type are sold.

Note: The codes below are printed on batteries containing harmful substances:

Pb = Battery contains lead

Cd = Battery contains cadmium

Hg = Battery contains mercury

Waste electrical devices marked with this sign must not be disposed of with your household waste, but are to be collected separately. Therefore, please return this device at the end of its life cycle to special collection points for disposal or your local dealer.

Waste electrical devices marked with this sign must not be disposed of with your household waste, but are to be collected separately. Therefore, please return this device at the end of its life cycle to special collection points for disposal or your local dealer.

Waste electrical devices marked with this sign must not be disposed of with your household waste, but are to be collected separately. Therefore, please return this device at the end of its life cycle to special collection points for disposal or your local dealer.

Waste electrical devices marked with this sign must not be disposed of with your household waste, but are to be collected separately. Therefore, please return this device at the end of its life cycle to special collection points for disposal or your local dealer.

Waste electrical devices marked with this sign must not be disposed of with your household waste, but are to be collected separately. Therefore, please return this device at the end of its life cycle to special collection points for disposal or your local dealer.

Waste electrical devices marked with this sign must not be disposed of with your household waste, but are to be collected separately. Therefore, please return this device at the end of its life cycle to special collection points for disposal or your local dealer.

Waste electrical devices marked with this sign must not be disposed of with your household waste, but are to be collected separately. Therefore, please return this device at the end of its life cycle to special collection points for disposal or your local dealer.

Waste electrical devices marked with this sign must not be disposed of with your household waste, but are to be collected separately. Therefore, please return this device at the end of its life cycle to special collection points for disposal or your local dealer.

Declaration of conformity

Protection Class I

Piesel-Piepser (Pee Sensor)

This product is developed, designed and manufactured in accordance with the EU directive on Radio Equipment Directive (2014/53/EU), under the sole responsibility by Osthoff-Vertriebungen, Eintrachtstr. 41, 40699 Erkrath

The following harmonized standards have been applied:

EN 301489

EN 300328

EN 62479

EN 60529

Waste electrical devices marked with this sign must not be disposed of with your household waste, but are to be collected separately. Therefore, please return this device at the end of its life cycle to special collection points for disposal or your local dealer.

Waste electrical devices marked with this sign must not be disposed of with your household waste, but are to be collected separately. Therefore, please return this device at the end of its life cycle to special collection points for disposal or your local dealer.

Waste electrical devices marked with this sign must not be disposed of with your household waste, but are to be collected separately. Therefore, please return this device at the end of its life cycle to special collection points for disposal or your local dealer.

Waste electrical devices marked with this sign must not be disposed of with your household waste, but are to be collected separately. Therefore, please return this device at the end of its life cycle to special collection points for disposal or your local dealer.

Waste electrical devices marked with this sign must not be disposed of with your household waste, but are to be collected separately. Therefore, please return this device at the end of its life cycle to special collection points for disposal or your local dealer.

Waste electrical devices marked with this sign must not be disposed of with your household waste, but are to be collected separately. Therefore, please return this device at the end of its life cycle to special collection points for disposal or your local dealer.

Waste electrical devices marked with this sign must not be disposed of with your household waste, but are to be collected separately. Therefore, please return this device at the end of its life cycle to special collection points for disposal or your local dealer.

Waste electrical devices marked with this sign must not be disposed of with your household waste, but are to be collected separately. Therefore, please return this device at the end of its life cycle to special collection points for disposal or your local dealer.

Waste electrical devices marked with this sign must not be disposed of with your household waste, but are to be collected separately. Therefore, please return this device at the end of its life cycle to special collection points for disposal or your local dealer.

Waste electrical devices marked with this sign must not be disposed of with your household waste, but are to be collected separately. Therefore, please return this device at the end of its life cycle to special collection points for disposal or your local dealer.

Waste electrical devices marked with this sign must not be disposed of with your household waste, but are to be collected separately. Therefore, please return this device at the end of its life cycle to special collection points for disposal or your local dealer.

Waste electrical devices marked with this sign must not be disposed of with your household waste, but are to be collected separately. Therefore, please return this device at the end of its life cycle to special collection points for disposal or your local dealer.

Waste electrical devices marked with this sign must not be disposed of with your household waste, but are to be collected separately. Therefore, please return this device at the end of its life cycle to special collection points for disposal or your local dealer.

Waste electrical devices marked with this sign must not be disposed of with your household waste, but are to be collected separately. Therefore, please return this device at the end of its life cycle to special collection points for disposal or your local dealer.

Waste electrical devices marked with this sign must not be disposed of with your household waste, but are to be collected separately. Therefore, please return this device at the end of its life cycle to special collection points for disposal or your local dealer.

Waste electrical devices marked with this sign must not be disposed of with your household waste, but are to be collected separately. Therefore, please return this device at the end of its life cycle to special collection points for disposal or your local dealer.

Waste electrical devices marked with this sign must not be disposed of with your household waste, but are to be collected separately. Therefore, please return this device at the end of its life cycle to special collection points for disposal or your local dealer.

Waste electrical devices marked with this sign must not be disposed of with your household waste, but are to be collected separately. Therefore, please return this device at the end of its life cycle to special collection points for disposal or your local dealer.

Waste electrical devices marked with this sign must not be disposed of with your household waste, but are to be collected separately. Therefore, please return this device at the end of its life cycle to special collection points for disposal or your local dealer.

Waste electrical devices marked with this sign must not be disposed of with your household waste, but are to be collected separately. Therefore, please return this device at the end of its life cycle to special collection points for disposal or your local dealer.

Waste electrical devices marked with this sign must not be disposed of with your household waste, but are to be collected separately. Therefore, please return this device at the end of its life cycle to special collection points for disposal or your local dealer.

Waste electrical devices marked with this sign must not be disposed of with your household waste, but are to be collected separately. Therefore, please return this device at the end of its life cycle to special collection points for disposal or your local dealer.

Waste electrical devices marked with this sign must not be disposed of with your household waste, but are to be collected separately. Therefore, please return this device at the end of its life cycle to special collection points for disposal or your local dealer.

Waste electrical devices marked with this sign must not be disposed of with your household waste, but are to be collected separately. Therefore, please return this device at the end of its life cycle to special collection points for disposal or your local dealer.

Waste electrical devices marked with this sign must not be disposed of with your household waste, but are to be collected separately. Therefore, please return this device at the end of its life cycle to special collection points for disposal or your local dealer.

Waste electrical devices marked with this sign must not be disposed of with your household waste, but are to be collected separately. Therefore, please return this device at the end of its life cycle to special collection points for disposal or your local dealer.

Waste electrical devices marked with this sign must not be disposed of with your household waste, but are to be collected separately. Therefore, please return this device at the end of its life cycle to special collection points for disposal or your local dealer.

Waste electrical devices marked with this sign must not be disposed of with your household waste, but are to be collected separately. Therefore, please return this device at the end of its life cycle to special collection points for disposal or your local dealer.

Waste electrical devices marked with this sign must not be disposed of with your household waste, but are to be collected separately. Therefore, please return this device at the end of its life cycle to special collection points for disposal or your local dealer.

Waste electrical devices marked with this sign must not be disposed of with your household waste, but are to be collected separately. Therefore, please return this device at the end of its life cycle to special collection points for disposal or your local dealer.

Waste electrical devices marked with this sign must not be disposed of with your household waste, but are to be collected separately. Therefore, please return this device at the end of its life cycle to special collection points for disposal or your local dealer.

